



Page 294
Prism Ø 50 135°
with screwed-in collar



Page 294
Prism Ø 50 135°
with screwed-in collar



Page 294
Prism Ø 50 135°
with screwed-in collar



Page 295
Vario Prism Ø 50 90° / 120°
with screwed-in collar



Page 295
Vario Prism Ø 50 90° / 120°
with screwed-in collar



Page 295
Vario Prism Ø 50 90° / 120°
with screwed-in collar



Page 296
Prism Ø 60 135°
with screwed-in collar



Page 296
Prism Ø 60 135°
with screwed-in collar



Page 296
Prism Ø 60 135°
with screwed-in collar



Page 297
Prism Ø 80 90°
with screwed-in collar



Page 297
Prism Ø 80 90°
with screwed-in collar



Page 297
Prism Ø 80 90°
with screwed-in collar



Page 298
Prism Ø 120 157°
with screwed-in collar



Page 298
Prism Ø 120 157°
with screwed-in collar



Page 298
Prism Ø 120 157°
with screwed-in collar



Page 299
Clamping Cone



Page 300
Prism Extension 25



Page 300
Prism Extension 50



Page 300
Prism Extension 100



Page 300
Prism Extension 150



Page 300
**Prism Collar Screw
with countersunk bolt**



Page 302
Set, Multi- Clamp Tower modular



Page 304
Set of Supports 11-piece set



Page 305
Screw Support Ø 80



Page 306
Support height adjustable with scale



Page 308
Spacer 100 Ø 50



Page 308
Spacer 150 Ø 50



Page 310
Clamping Pipe with quick fastener



Prisms

All System 28 Prisms are equipped with a removable screwed-in collar.

Included in delivery of each Prism is a screwed-in collar and a countersunk bolt.

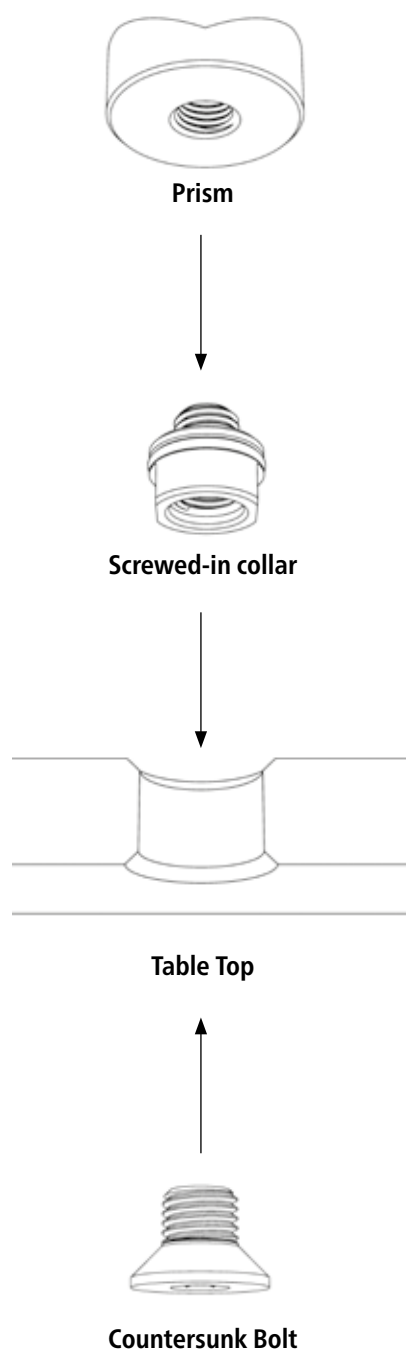

PRISM Ø 50 135°

Page 294

STYLES

Burnished
Aluminum
Polyamide



VARIO PRISM Ø 50 90° / 120°

Page 295

STYLES

Burnished / nitrided
Aluminum
Polyamide



PRISM Ø 60 135°

Page 296

STYLES

Burnished
Aluminum
Polyamide



PRISM Ø 80 90°

Page 297

STYLES

Burnished / nitrided
Aluminum
Polyamide



PRISM Ø 120 157°

Page 298

STYLES

Burnished / nitrided
Aluminum
Polyamide



You can also
find the product
video on:

[www.siegmund.com/
V280645](http://www.siegmund.com/V280645)



WITH COLLAR IN BORE HOLE

Prism with collar is applicable for all System 28 boreholes, and provides a sturdy support surface for pipes.



WITHOUT COLLAR ON TABLE

All System 28 Prisms can be used without collar. Consequently they can be positioned on the table independently from the hole grid.

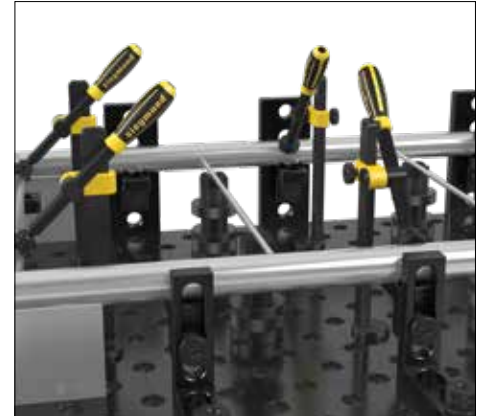

WITH PRISM EXTENSION

If required, a prism extension can be screwed in. It enables positioning at different heights, in combination with spacer washers and support discs. In combination with the screw support infinitely variable positioning is possible.

See Set of Supports (Item No. 280821) or
Screw Support (Item No. 280822).

PRISM EXTENSION

It can be quickly and securely screwed into all Prisms.



Application



280649.3



280649.2



280649.1



280649

Prism Ø 50 135° with screwed-in collar



280648.1



280648.1.A



280648.1.PA

Description:

Prism Ø 50 135° provides a stable support surface for pipes with a diameter up to 80 mm.

The prism with screwed-in collar can be fastened in the bore holes and securely fixed using the M16 countersunk screw (Item No. 009410). For free positioning of the prism independent of the hole grid you can easily unscrew the collar from the prism. If necessary, the working height of the prism can be varied by a prism extension.

Polyamid Prisms are used for scratch-prone surfaces.

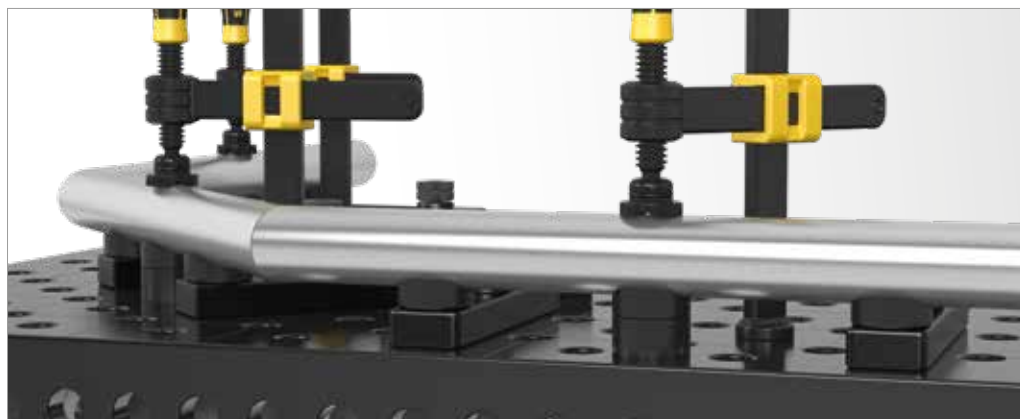

	Height: (c)	Ø: (o)	Weight:	Item No.
Prism Ø 50 135° with screwed-in collar - burnished - M16 thread for example prism extensions Item No. 280649	20 mm	50 mm	0,20 kg	2-280648.1 ●
Prism Ø 50 135° with screwed-in collar - Aluminum - M16 thread for example prism extensions Item No. 280649	ALU 20 mm	50 mm	0,07 kg	2-280648.1.A ●
Prism Ø 50 135° with screwed-in collar - Polyamide - M16 thread for example prism extensions Item No. 280649	PA 20 mm	50 mm	0,03 kg	2-280648.1.PA ●

● = Item produced for stock; ○ = Item produced on order; Explanations see page 84

Vario Prism Ø 50 90°/120° with screwed-in collar

Description:

Vario Prism, suitable for both rounded and 45° twisted square pipes with a diameter of up to 50 mm.

The prism with screwed-in collar can be fastened in the bore holes and securely fixed using the M16 countersunk screw (Item No. 009410). For free positioning of the prism independent of the hole grid you can easily unscrew the collar from the prism. If necessary, the working height of the prism can be varied by a prism extension.

Polyamid Prisms are used for scratch-prone surfaces.



280645.1



280645.1.A



280645.1.PA

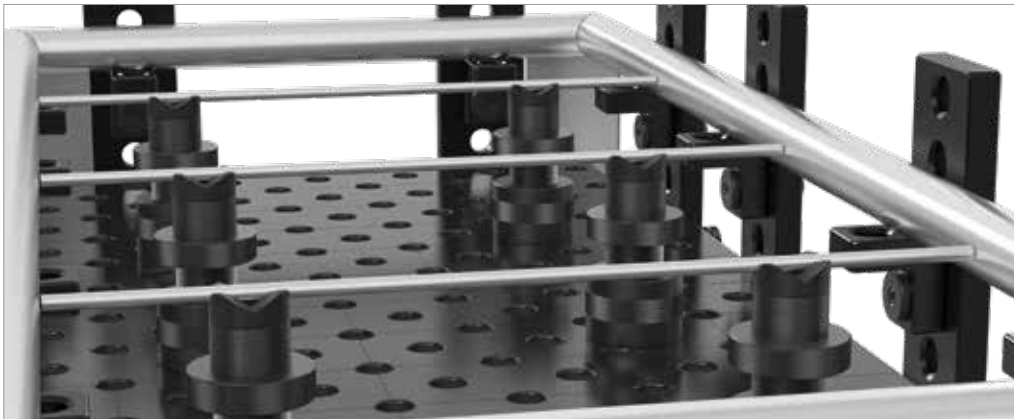

	Height: (c)	Ø: (o)	Weight:	Item No.
Vario Prism Ø 50 90° / 120° with screwed-in collar - burnished / nitrided - M16 thread for example prism extensions Item No. 280649	20 mm	50 mm	0,20 kg	2-280645.1 ●
Vario Prism Ø 50 90° / 120° with screwed-in collar - Aluminum - M16 thread for example prism extensions Item No. 280649	ALU 20 mm	50 mm	0,07 kg	2-280645.1.A ●
Vario Prism Ø 50 90° / 120° with screwed-in collar - Polyamide - M16 thread for example prism extensions Item No. 280649	PA 20 mm	50 mm	0,03 kg	2-280645.1.PA ●

● = Item produced for stock; ○ = Item produced on order; Explanations see page 84

Prism Ø 60 135° with screwed-in collar



280651.1



280651.1.A



280651.1.PA

Description:

Prism Ø 60 135°, especially suitable for pipes with a diameter up to 80 mm.

The prism with screwed-in collar can be fastened in the bore holes and securely fixed using the M16 countersunk screw (Item No. 009410). For free positioning of the prism independent of the hole grid you can easily unscrew the collar from the prism. If necessary, the working height of the prism can be varied by a prism extension.

Polyamid Prisms are used for scratch-prone surfaces.



	Height: (c)	Ø: (o)	Weight:	Item No.
Prism Ø 60 135° with screwed-in collar - burnished - M16 thread for example prism extensions Item No. 280649	30 mm	60 mm	0,52 kg	2-280651.1 ●
Prism Ø 60 135° with screwed-in collar - Aluminum - M16 thread for example prism extensions Item No. 280649	ALU 30 mm	60 mm	0,18 kg	2-280651.1.A ●
Prism Ø 60 135° with screwed-in collar - Polyamide - M16 thread for example prism extensions Item No. 280649	PA 30 mm	60 mm	0,08 kg	2-280651.1.PA ●

● = Item produced for stock; ○ = Item produced on order; Explanations see page 84

Prism Ø 80 90° with screwed-in collar

Description:

Prism Ø 80 90°, creates a solid support surface for pipes with diameters up to 100 mm, as well as for all rectangular pipes.

The prism with screwed-in collar can be fastened in the bore holes and securely fixed using the M16 countersunk screw (Item No. 009410). For free positioning of the prism independent of the hole grid you can easily unscrew the collar from the prism. If necessary, the working height of the prism can be varied by a prism extension.

Polyamid Prisms are used for scratch-prone surfaces.

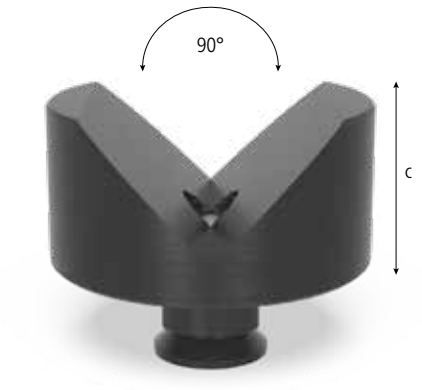

280647.1



280647.1.A



280647.1.PA

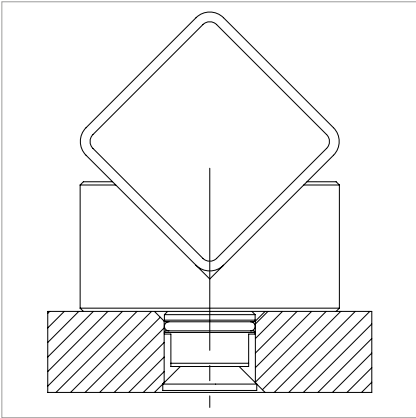

	Height: (c)	Ø: (o)	Weight:	Item No.
Prism Ø 80 90° with screwed-in collar - burnished / nitrided - M16 thread for example prism extensions Item No. 280649	40 mm	80 mm	1,01 kg	2-280647.1 ●
Prism Ø 80 90° with screwed-in collar - Aluminum - M16 thread for example prism extensions Item No. 280649	ALU 40 mm	80 mm	0,55 kg	2-280647.1.A ●
Prism Ø 80 90° with screwed-in collar - Polyamide - M16 thread for example prism extensions Item No. 280649	PA 40 mm	80 mm	0,19 kg	2-280647.1.PA ●

● = Item produced for stock; ○ = Item produced on order; Explanations see page 84

Prism Ø 120 157° with screwed-in collar

Description:

Prism Ø 120 with 157° angle, designed for large pipes with a diameter of up to 400 mm. Above all, it creates a solid support surface for round pipes.

The prism with screwed-in collar can be fastened in the bore holes and securely fixed using the M16 countersunk screw (Item No. 009410). For free positioning of the prism independent of the hole grid you can easily unscrew the collar from the prism. If necessary, the working height of the prism can be varied by a prism extension.

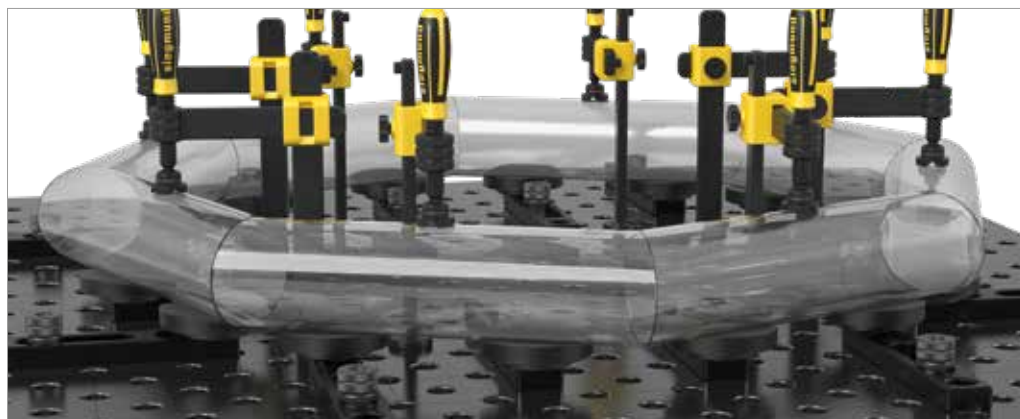
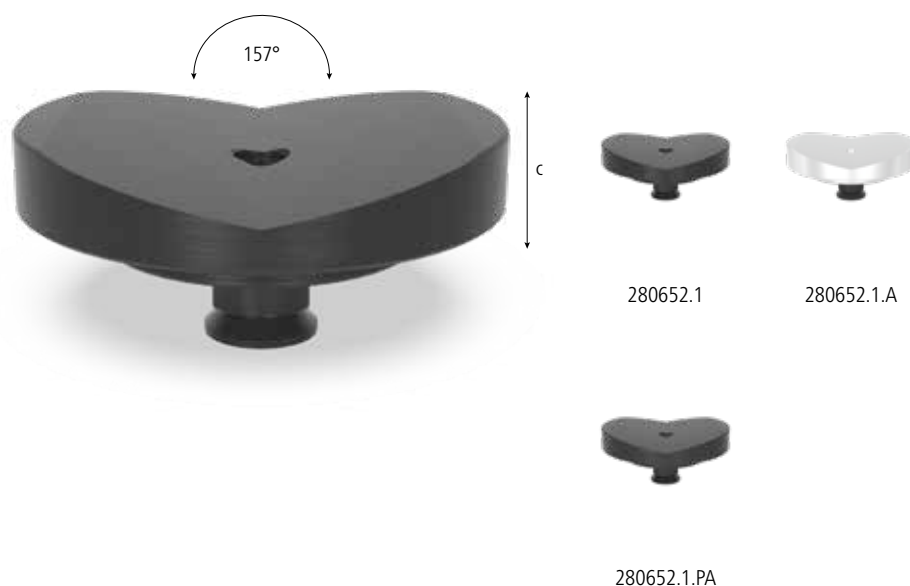

	Height: (c)	Ø: (o)	Weight:	Item No.
Prism Ø 120 157° with screwed-in collar - burnished / nitrided - M16 thread for example prism extensions Item No. 280649	30 mm	120 mm	1,70 kg	2-280652.1 ●
Prism Ø 120 157° with screwed-in collar - Aluminum - M16 thread for example prism extensions Item No. 280649	ALU 30 mm	120 mm	0,70 kg	2-280652.1.A ●
Prism Ø 120 157° with screwed-in collar - Polyamide - M16 thread for example prism extensions Item No. 280649	PA 30 mm	120 mm	0,30 kg	2-280652.1.PA ●

● = Item produced for stock; ○ = Item produced on order; Explanations see page 84

Clamping Cone

Description:

Clamping Cone, enables clamping of round and square pipes with a diameter of up to < 80 mm, by simply positioning them. The Clamping Cone is fastened with bolts.



280670



	Height: (c)	Ø: (o)	Weight:	Item No.
Clamping Cone - burnished / nitrided	70 mm	80 mm	1,40 kg	2-280670 ●

● = Item produced for stock; ○ = Item produced on order; Explanations see page 84

Prism Extension



Description:

The Prism extension can be quickly and securely screwed in all prisms and enables positioning of the prism at different heights in combination with spacers (Item No. 280821).

With the screw support (Item No. 280822) an infinitely variable positioning is possible.

Due to the width flat, the Prism Extension can be fastened to the prism or attached to a custom construction.

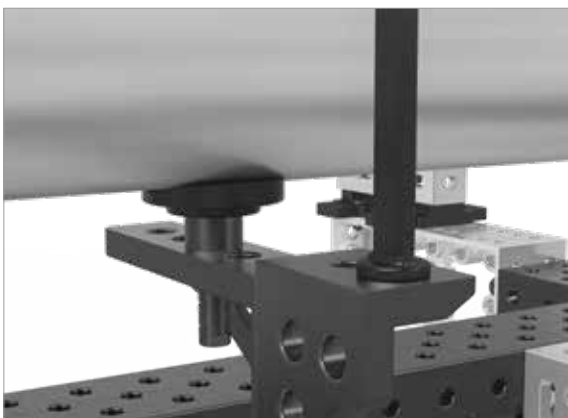



	Length: (a)	Ø: (o)	Weight:	Item No.
Prism Extension 25 - burnished	25 mm	28 mm	0,11 kg	2-280649 ●
Prism Extension 50 - burnished	50 mm	28 mm	0,22 kg	2-280649.1 ●
Prism Extension 100 - burnished	100 mm	28 mm	0,45 kg	2-280649.2 ●
Prism Extension 150 - burnished	150 mm	28 mm	0,69 kg	2-280649.3 ●
Prism Collar Screw with countersunk bolt - burnished	17 mm	28 mm	0,14 kg	2-280669 ●
Countersunk Bolt M16 - spare part - for prisms system 28	20 mm	29 mm	0,07 kg	2-009410 ●

● = Item produced for stock; ○ = Item produced on order; Explanations see page 84

Upon request, all parts are available in aluminum or polyamide version.

Multi Clamp Tower Modular

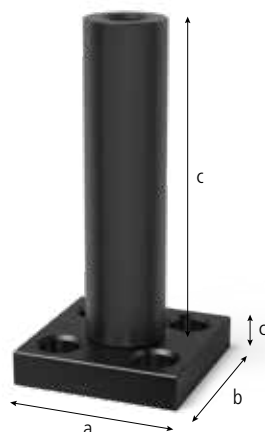

280646.5



280646



280646.1



280646.2



280646.3



280646.4



280617.5H

Description:

Multi Clamp Tower, serves as an extension for various components, such as screw clamps, prisms, spacers and similar elements. Bolts are used to quickly fasten Multi Clamp Towers to tables or other components, creating a sturdy support surface. The table top and compatible vertical pipe are bolted together.

To increase sturdiness, the pipe can be welded by the customer.

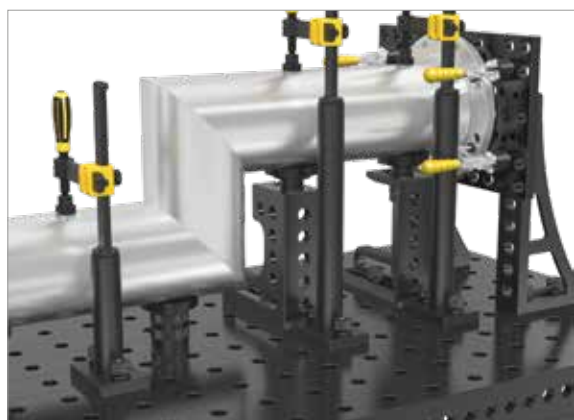

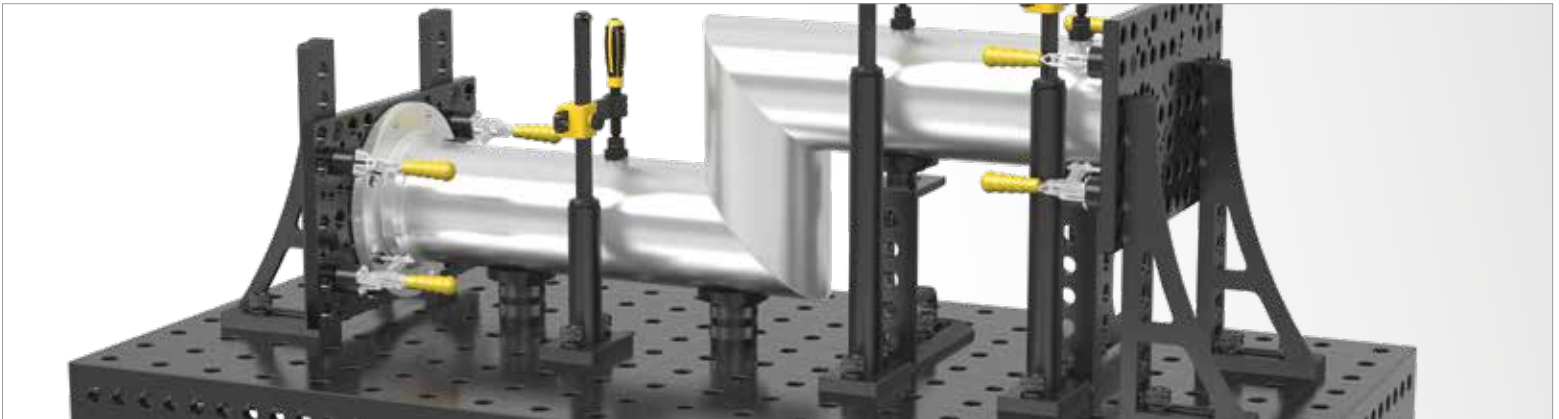

	Length: (a)	Width: (b)	Height: (c)	Ø: (o)	Weight:	Item No.
Plate, Large - for Multi Clamp Tower modular	150 mm	100 mm	25 mm		2,60 kg	2-280646.5 ●
Plate, Small - for Multi Clamp Tower modular	120 mm	120 mm	25 mm		2,23 kg	2-280646 ●
Vertical Pipe 225 - for Multi Clamp Tower modular			225 mm	57 mm	1,70 kg	2-280646.1 ●
Vertical Pipe 475 - for Multi Clamp Tower modular			475 mm	57 mm	2,94 kg	2-280646.2 ●
Vertical Pipe 725 - for Multi Clamp Tower modular			725 mm	57 mm	4,24 kg	2-280646.3 ●
Vertical Pipe 975 - for Multi Clamp Tower modular			975 mm	57 mm	5,54 kg	2-280646.4 ●
Cast Iron Cross incl. Handwheel - for Multi Clamp Tower modular - for 280638 (see page 267)	104 mm	80 mm	56 mm		1,27 kg	2-280617.5H ●

● = Item produced for stock; ○ = Item produced on order; Explanations see page 84



Set of Supports 11-piece set

Description:

11-piece Set of Supports, offers the option to vary the height of the support surface. The individual supports can be used to compensate for 1-100 mm height differences. The lowest grading of the supports is 1 mm, in order to achieve the intended height precisely. The measurements are specified on the particular discs. Aided by the O-rings, the Supports can be adjusted easily and precisely. The Set of Supports can be universally used in all drill holes of system 28. The M10 thread on the inside of the supports enables fastening of customer-specific components or prisms.



280821



280821.1



280821.2

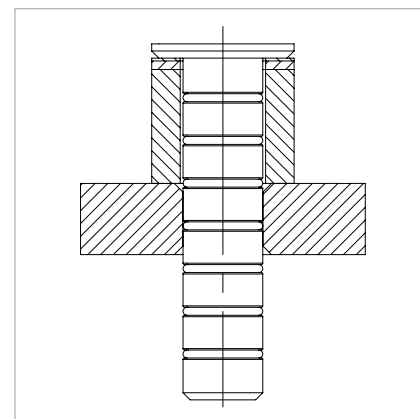
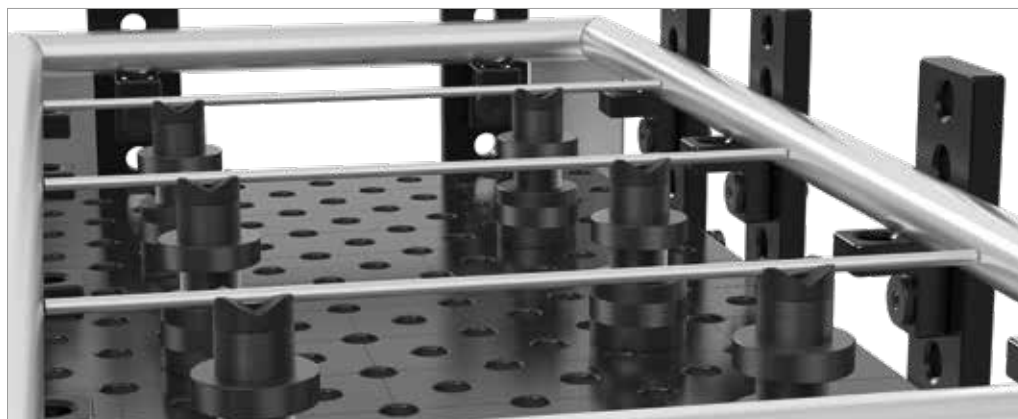

	Height: (c)	Ø: (o)	Weight:	Item No.
Set of Supports 11-piece set - burnished	125 mm	50 mm	1,95 kg	2-280821 ●
Tower for Supports - burnished	125 mm	50 mm	0,60 kg	2-280821.1 ●
Washer Set - gradation of discs: 1 / 2 / 3 / 4 / 5 mm 10 / 20 / 40 / 50 mm incl. 1/10" disc 2,54 mm		50 mm	1,35 kg	2-280821.2 ●

● = Item produced for stock; ○ = Item produced on order; Explanations see page 84

Screw Support Ø 80

Description:

Screw Support, especially intended for Vernier height adjustments ranging from 75-110 mm. The height compensation can be clearly increased by using prism extensions and the set of Supports.



280822

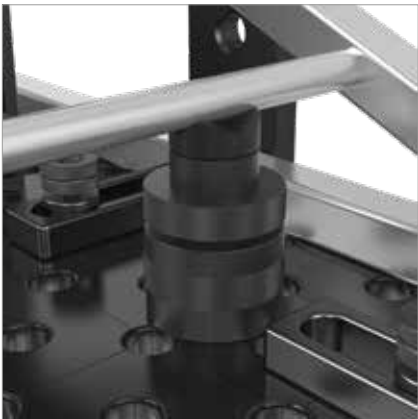

	Height: (c)	Ø: (o)	Weight:	Item No.
Screw Support Ø 80 - burnished	75-110 mm	80 mm	2,30 kg	2-280822 ●

● = Item produced for stock; ○ = Item produced on order; Explanations see page 84

Support height adjustable with scale



280824

Description:

The height adjustable Support with scale offers a solid support surface and can be used in all system bore holes.

The height can be adjusted steplessly in the range of 20 – 105 mm by regulating the adjusting ring and the locknut. Due to the fine scaling, the height can be adjusted accurate to the millimetre.

Available from 01.04.2019.





	Length: (a)	Ø: (o)	Weight:	Item No.
Support height adjustable with scale - incl. Setscrew	144 mm	50 mm	0,87 kg	2-280824 ●

● = Item produced for stock; ○ = Item produced on order; Explanations see page 84

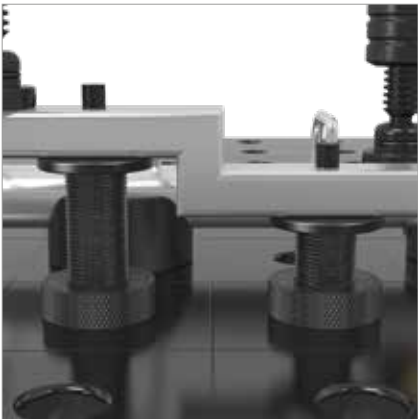

Spacer

Description:

Spacer - universally usable in combination with the threaded bushing for M16 threads (Item No. 280825) and a square or stop. Any distance can be adjusted quickly and precisely by using the simple rotation mechanism. In general, a screw clamp, try square or something similar, serve as a counterpart to the Spacer.

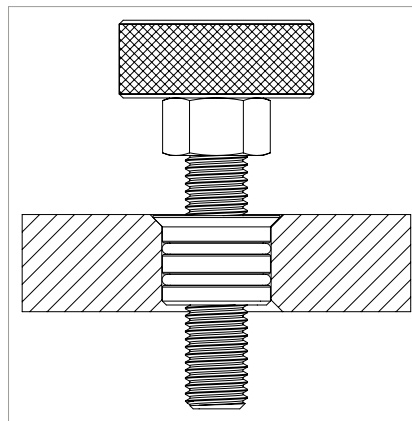
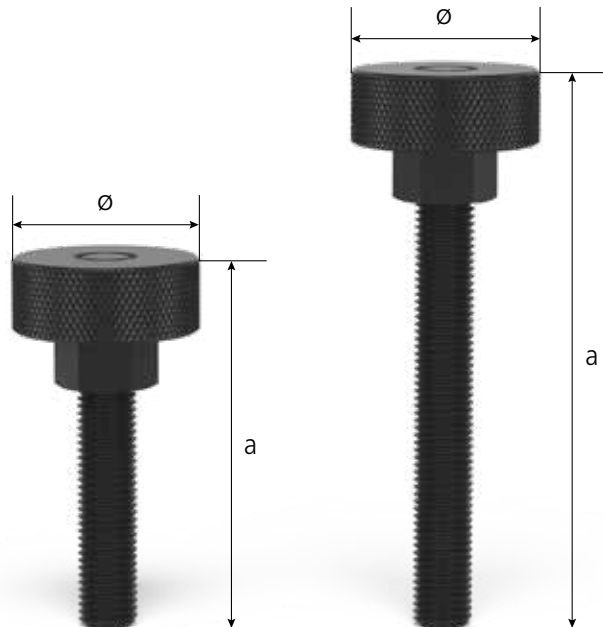



280175.1



280176



280825

	Length: (a)	Height: (c)	Ø: (o)	Weight:	Item No.
Spacer 100	100 mm		50 mm	0,52 kg	2-280175 •
	100 mm		75 mm	0,92 kg	2-280176 •
	100 mm		100 mm	1,42 kg	2-280177 •
Spacer 150	150 mm		50 mm	0,60 kg	2-280175.1 •
	150 mm		75 mm	1,00 kg	2-280176.1 •
	150 mm		100 mm	1,50 kg	2-280177.1 •
Thread Bushing for M16 thread - burnished		23 mm	30 mm	0,07 kg	2-280825 •



Clamping Pipe with quick fastener



280750



280760



280760.1



280662.N

Description:

Clamping pipe with integrated fast clamping bolt, allows backlash-free fastening of a system 28 clamping pipe. Screw clamps, quick-release clamps, height and side stops and other components can be mounted on it.

Further application options and components can be found in the internet.

Angle Bushing / -Sleeve, can be flexibly used in conjunction with a Clamping Pipe (Item No. 280750 + 280642).

By using a Threaded Bushing (Item No. 280618), the Angle Bushing / -Sleeve can be used in combination with a threaded arbor.

Axial distance arbor 40 mm.

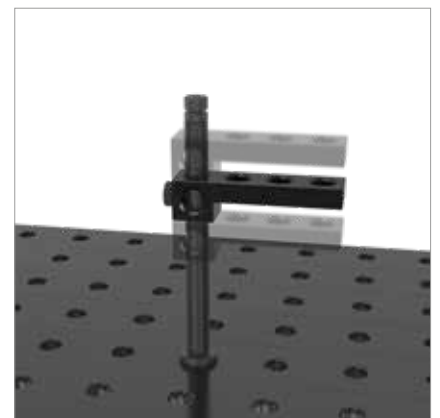
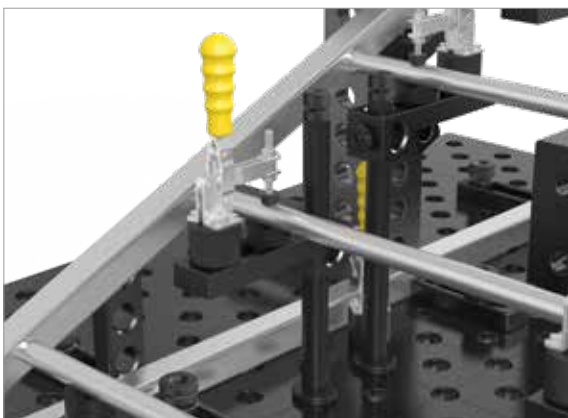

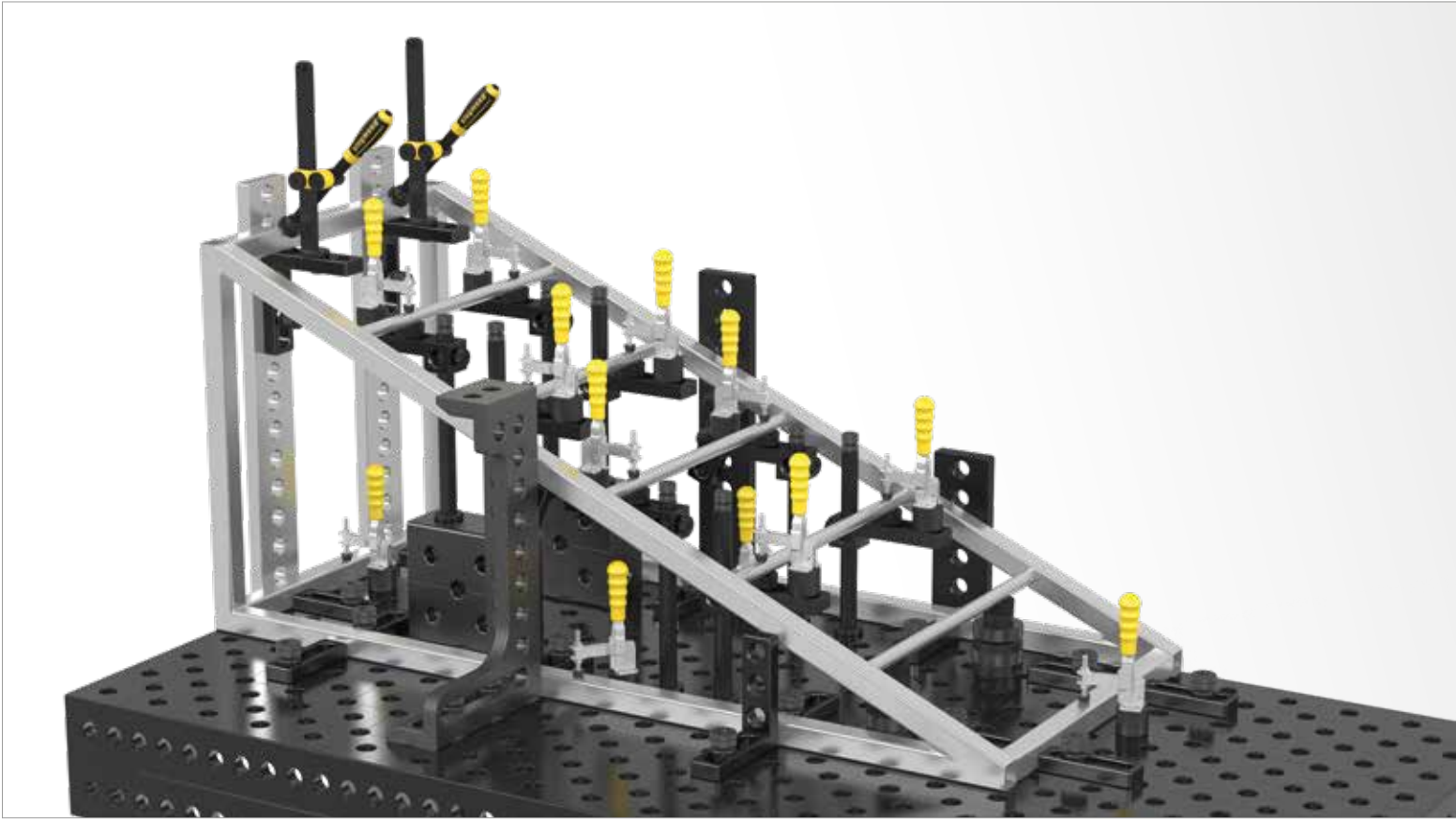

	Length: (a)	Width: (b)	Height: (c)	Ø: (o)	Weight:	Item No.
Clamping Pipe with quick fastener			380 mm	28 mm	1,80 kg	2-280750 ●
Additional sizes upon request						○
Clamp Stop	200 mm	50 mm	50 mm	28 mm	1,66 kg	2-280760 ●
Clamp Stop - with oblong slot	200 mm	50 mm	50 mm		1,37 kg	2-280760.1 ●
Handwheel for Cast Iron Cross - for 280610, 280612, 280630, 280615, 280611, 220610.1, 220630.1, 220615.1	25 mm			30 mm	0,06 kg	2-280662.N ●

● = Item produced for stock; ○ = Item produced on order; Explanations see page 84

